

This photo-etched detail set is designed to enhance the excellent Sweet Hurricane Mk.I kits. As the Sweet boxings usually include 2 kits this set caters both of them.

Somewhat unusually for us, we will take a peek into the cockpit (PC) first. The pilot seat (3) needs to be folded, fitted with the harness (5, 6) and placed onto the rectangle part of the cockpit floor (1). The rudder pedals (2) and the control stick (7) are accompanied by the instrument panel (8). Please note, the compass on the bottom of the dashboard needs to be bent up to make the straight angle with a face of the instrument panel. To make the whole cockpit assembly fit nicely within the fuselage the inner shelves of the kit's cockpit area need to be lowered by 1 mm. The headrest plate should be placed after the fuselage halves are joined together to mask the seam.

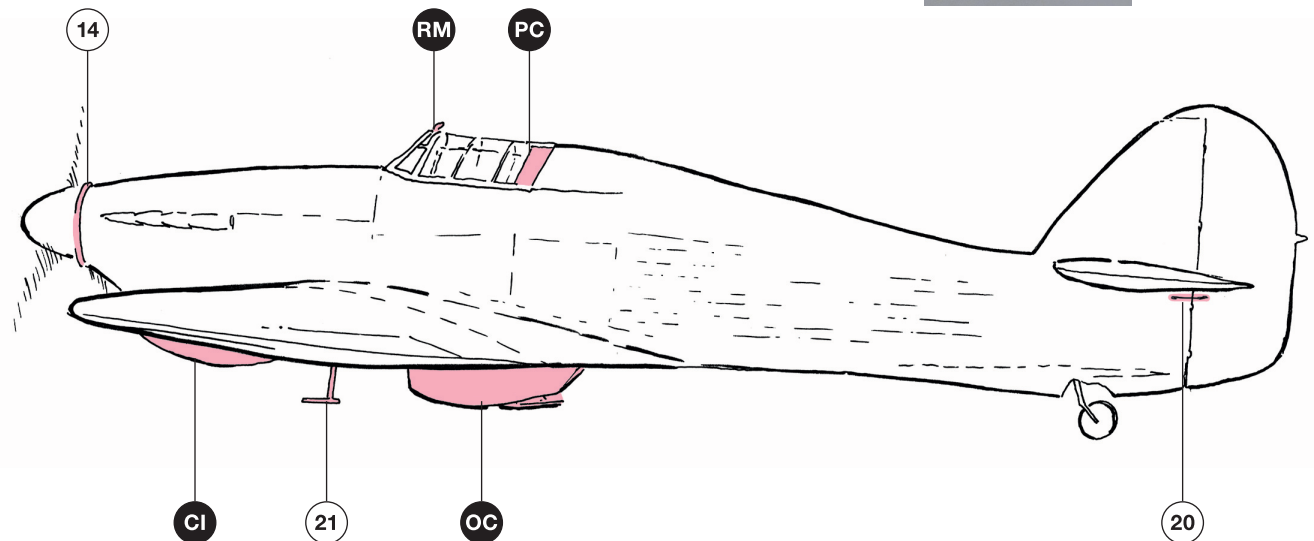

The carburettor air intake lips (CI) for the tropical Hurricane versions (9) are included as well as one for the standard version (10). The front (11) and rear oil radiator grill (12) should be attached before joining the oil cooler (OC) halves together. If you additionally want to display the rear cooling flap (13) in the opened position a small surgery will be needed. Two small round notches on the inner side of the flap indicate the places where the flap actuators should be attached. Two 2 mm long pieces of 0.1 mm wire should just do.

Some airframes were fitted with an oil-sealing ring (14) placed immediately behind the propeller hub, observe your references here.

The Hurricane night fighters were usually fitted with flame dampers (17L, 17R) placed on both sides of the fuselage on front of the cockpit.

As some parts of the Hurricane were slightly different between production batches we have included two kinds of blade antennae mast (AM) (15, 16). The third option would be the 5 mm long piece of 0.2 mm wire. The short tail mast in either option can be simulated by 1 mm long piece of 0.2 mm wire.

The remaining details are the representation of characteristic RAF-style landing lights (18), the vertical rudder actuators (20) placed symmetrically on both sides of the fuselage and the underwing pitot probe (21).

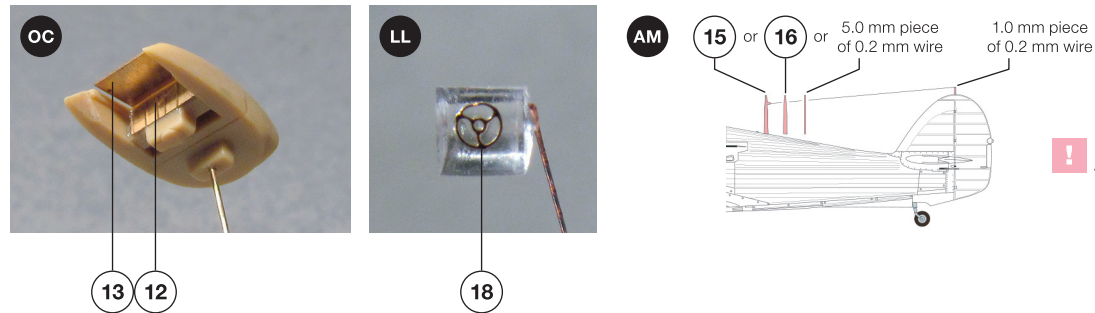
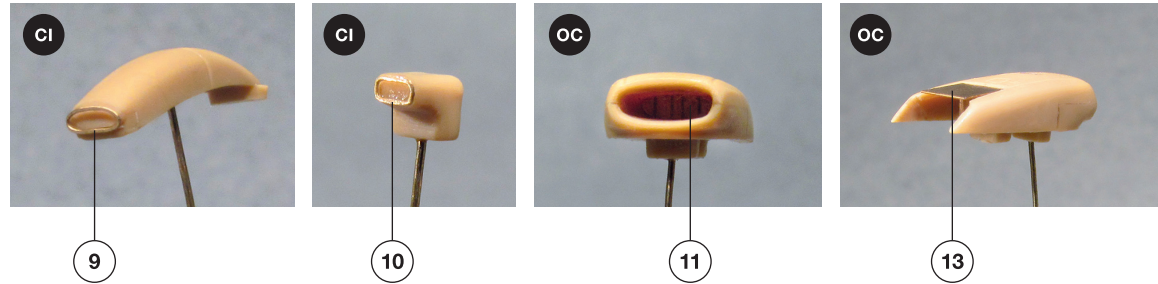

! Drawing keeps 1/144 scale when printed on A4 size paper without "fit to page" option.

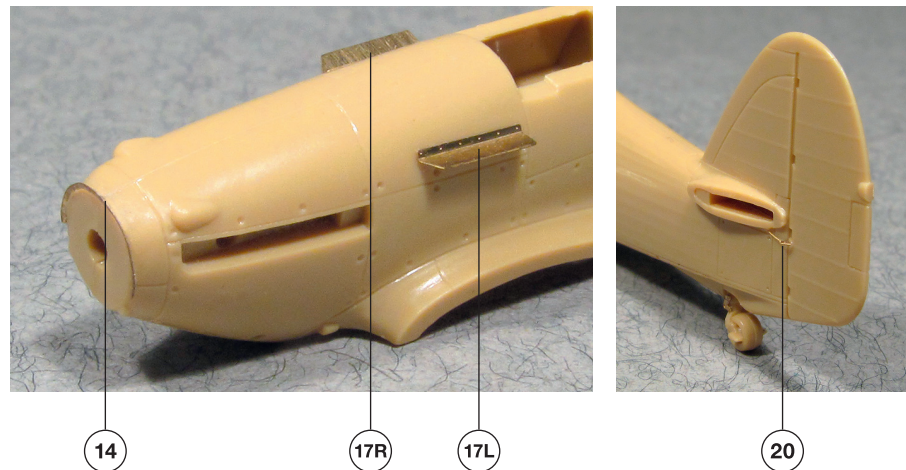

The pilot rear-view mirror (RM) is also the detail which was different on a different planes – some were fitted with the rectangular one (29) and some with the circular one (30). Both versions of the mirror were placed on a short stub (28) which needs to be folded in half first. The cockpit limousine was sometimes fitted with outside handles and sometimes with the inside ones. They both can be represented by parts no.19. Unfortunately due to thickness of the kit's transparency placing the inner handles will not be sensible idea unless its Brengun (BRL144135) vacformed replacement is used. For clarity we have used here the solid plastic canopies included in every Sweet Hurricane set.

To reach the aforementioned canopy the retractable pilot's step (PS) might be needed. If you want to keep the step closed the flat part no. 24 can be used. If the opened step is what you are after – the simple combination (25+22) or the more adventurous one (25+23+26+27) can be used.

The last bit are the rear wheel scissors (31) which can be used to upgrade the rear wheel assembly to a later version used sometimes in Mk.I (or Mk.X) airframes. See our decal sheet SO314412 – RAATG Silver Hurricanes.

We do like our home pe(s)ts – so our floor-based friend might be happy again as there are several spare items included on the fret.

### Sources:

- Hawker Hurricane – Modelmania 04 by AJ-Press
- Hawker Hurricane Vol.1-4 – Monografie Lotnicze 51-54 by AJ-Press
- Hawker Hurricane – Aeroplane Icons
- Hawker Hurricane – Klub SP 01 by WKiL

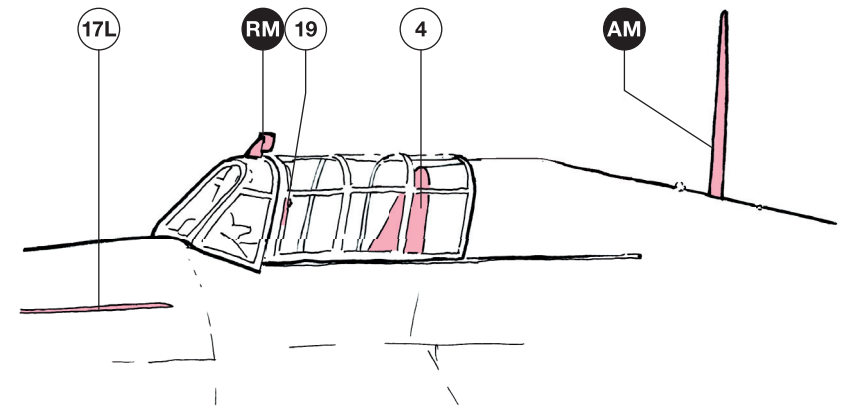
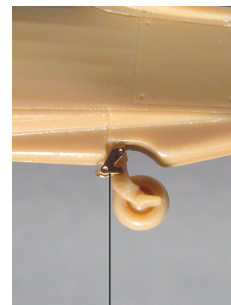
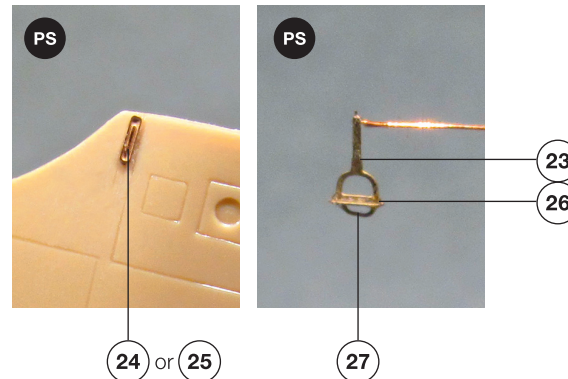
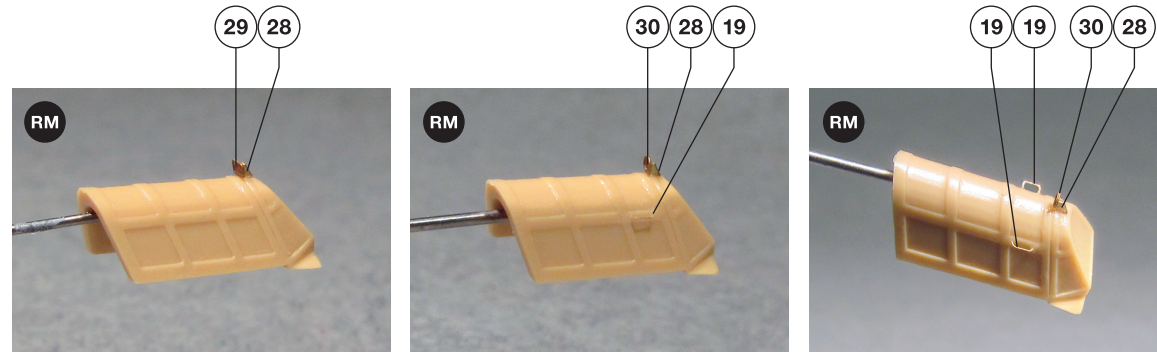

31